

# Ace Roto-Mold

## Product *Change* Notification

*Den Hartog Industries is excited to introduce a 2" Male Pipe Thread fitting option available on our 85 and 110 Gallon Full Drain Inductor Tanks. These tanks will now be available with either standard 2" FNPT or 2" MNPT fitting option. The tank's properties remain unchanged.*

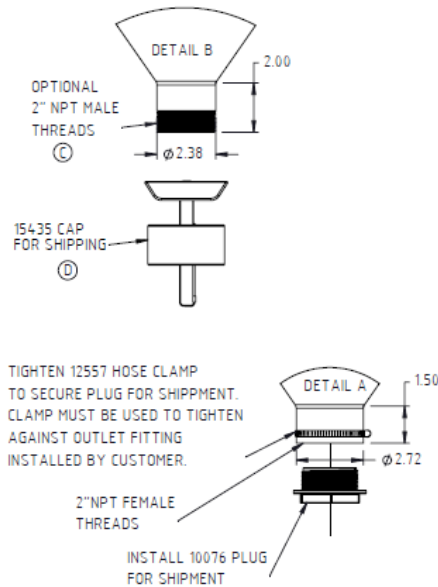

Tank shown is the INFD85-30  
With the 2" MPT outlet.

### FEATURES for the Inductor Tank Line:

- Conical bottoms facilitate liquid drain out.
- Gallon Indicators are included in the sidewall.
- Tanks manufactured from Linear Low Density Polyethylene with U.V. stabilizers.
- Standard color is white.
- Standard weight tank is designed for chemicals with a specific gravity of 1.7. Consult the Application Guideline Manual for known compatible chemicals and service temperatures.
- Tanks require stands to support conical bottom.

October 2024



"Always at Your Service"



**Warning:** Cancer and Reproductive Harm.  
[www.p65Warnings.ca.gov](http://www.p65Warnings.ca.gov)

Ph: 800-342-3408  
Fax: 712-752-8222

[www.denhartogindustries.com](http://www.denhartogindustries.com)  
[sales@denhartogindustries.com](mailto:sales@denhartogindustries.com)

4010 Hospers Dr. South  
Hospers, IA 51238

Copyright: All information furnished within this document, electronic file or design correspondence is the property of Den Hartog Industries, Inc. and shall not be used, disclosed to others or copied without the expressed written consent of Den Hartog Industries, Inc.

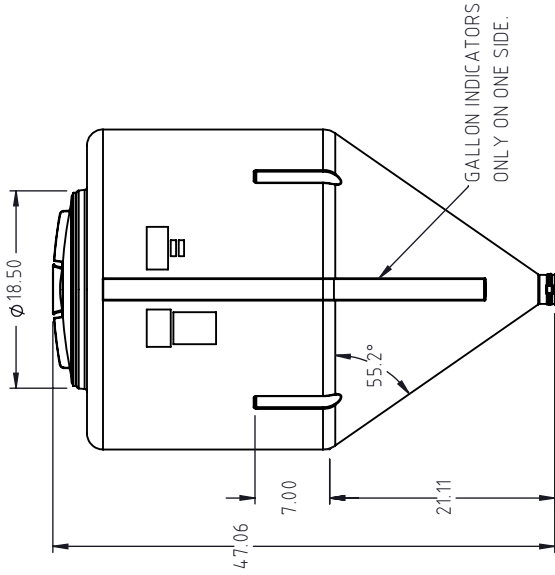
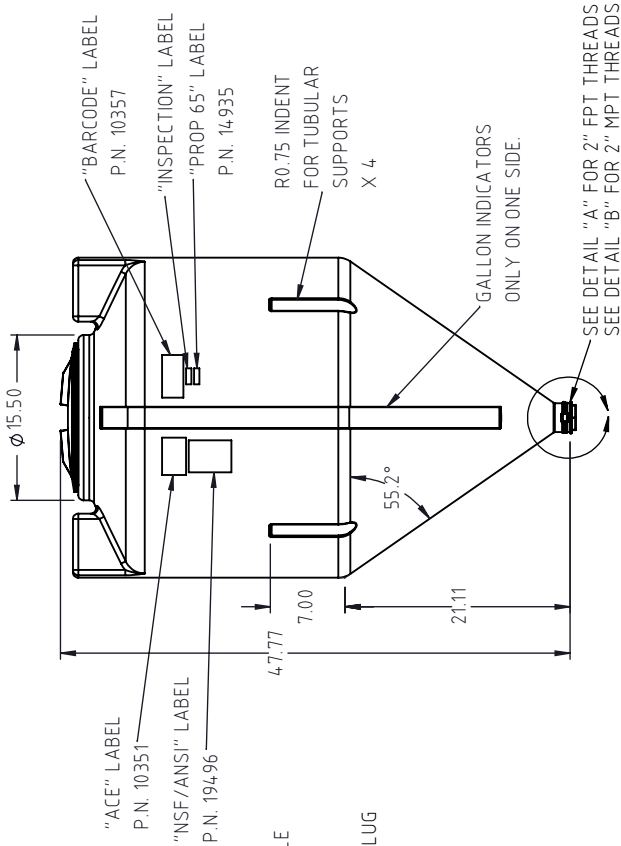
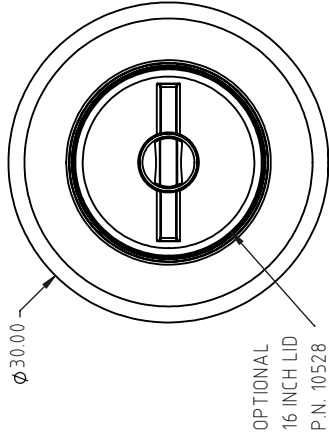
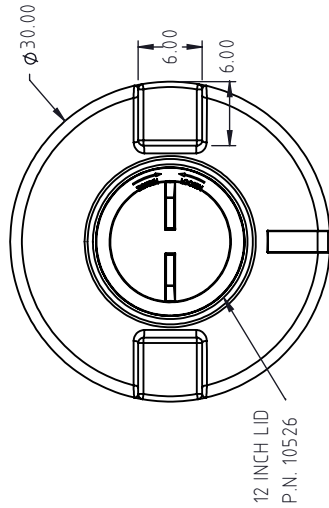
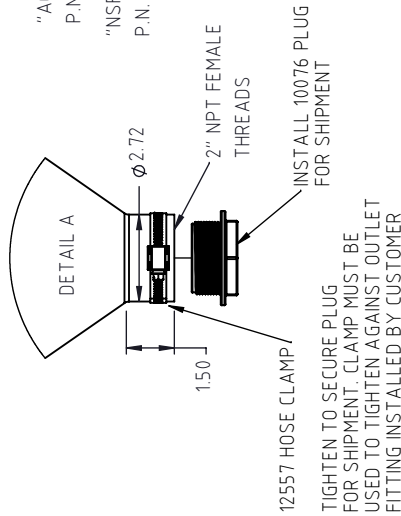
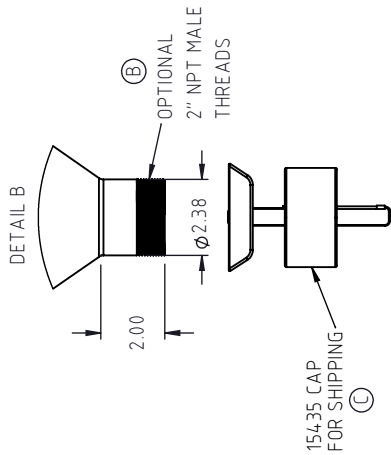

C	15435 WAS SC2.00RD-4 CAP.	BES	10/11/2024	4648	DRAWN / DATE	MATERIAL : LLDPE	
B	ADDED ANGLE AND UPDATED LAYOUT. ADDED MALE THREAD DETAIL	SRA	8/26/24	4542	DHJ 10/26/2005	NOTES: 1) 0.23" NOM. WALL	
A	BOM TABLE ADDED. 16" LID DETAIL SHEET ADDED.	ADH	2/1/2023	4384	APPRD. / DATE	SCALE N.S. PART NO. INFD85-30	
REV.	DESCRIPTION	BY	DATE	CCN	DHJ 6/22/2009	DESCRIPTION 85 GALLON FULL DRAIN INDUCTOR TANK	
ALL DIMENSIONS ARE IN DECIMAL INCHES TOLERANCES UNLESS OTHERWISE SPECIFIED		THIRD ANGLE PROJECTION ANSI 14.5W		SHOT WEIGHT: 35.0 LBS		SHEET 1 OF 1	
POLYETHYLENE		+		SHIPPING WEIGHT: 37.0 LBS		FINISH:	
±1% @ 68°F		DECIMAL ± .125" FRACTION ± 1/4" ANGLE ± 1°					



**Den Hartog INDUSTRIES, INC.**

Ace Roto-Mold • Injection Molding • Blow Molding • Sowjoy  
4010 HOSPERS DRIVE S. BOX 425, HOSPERS, IOWA 51238-0425

**© DEN HARTOG INDUSTRIES, INC.**

Copyright: All information furnished within this document, electronic file or design correspondence is the property of Den Hartog Industries, Inc. and shall not be used, disclosed to others or copied without the expressed written consent of Den Hartog Industries, Inc.

TIGHTEN 12557 HOSE CLAMP TO SECURE PLUG FOR SHIPMENT. CLAMP MUST BE USED TO TIGHTEN AGAINST OUTLET FITTING INSTALLED BY CUSTOMER.

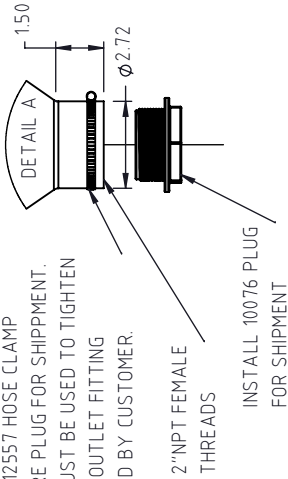

2" NPT FEMALE  
THREADS

INSTALL 10076 PLUG  
FOR SHIPMENT

"ACE" LABEL  
P.N. 10352  
"WARNING" LABEL  
P.N. 10353  
"NSF/ANSI" LABEL  
P.N. 19496

"BARCODE" LABEL  
P.N. 10357  
"INSPECTION" LABEL  
"PROP. 65" LABEL  
P.N. 14935

GALLON  
MARKER

SEE DETAIL "A" FOR 2" FPT THREADS  
SEE DETAIL "B" FOR 2" MPT THREADS

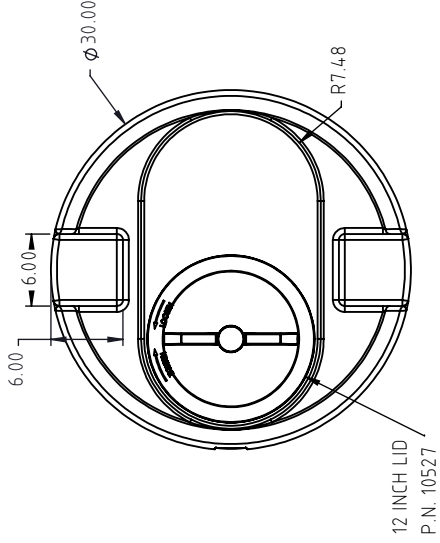

12 INCH LID  
P.N. 10527

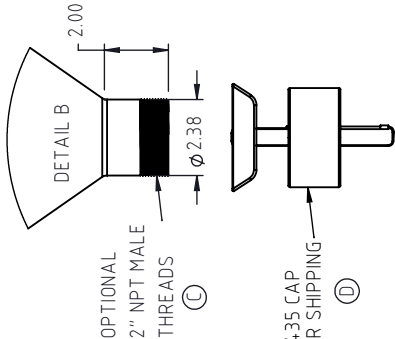

OPTIONAL  
2" NPT MALE  
THREADS

15435 CAP  
FOR SHIPMENT

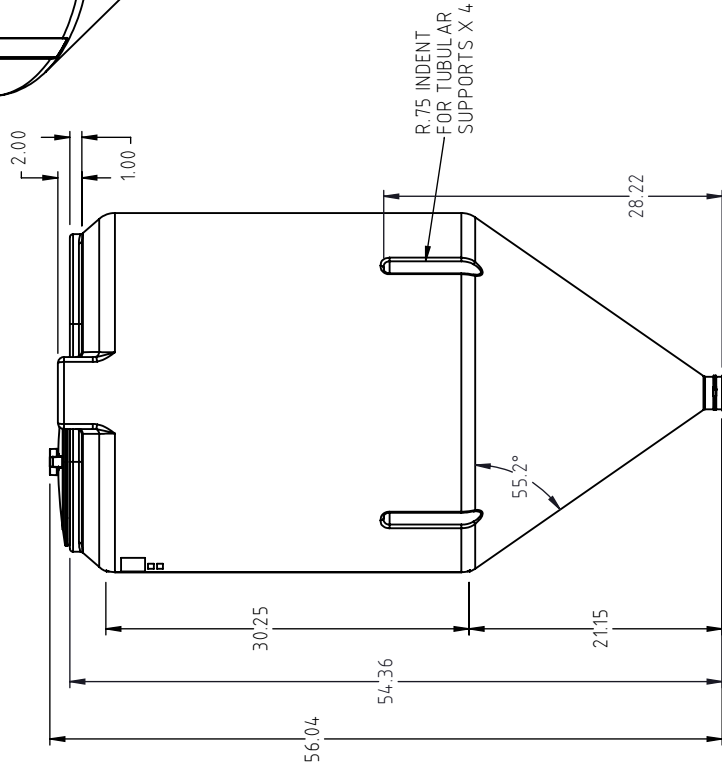

R.75 INDENT  
FOR TUBULAR  
SUPPORTS X 4

INFD110-30

D



**Den Hartog  
INDUSTRIES, INC.**

**Ace Roto-Mold • Injection Molding • Blow Molding • Sowjoy**  
4010 HOSPERS DRIVE S. BOX 425, HOSPERS, IOWA 51238-0425

©

MATERIAL :  
LLDPE

DRAWN / DATE  
DHJ 10/26/2009

APPRD. / DATE  
REH 11/2/2009

SHOT WEIGHT: 4.20 LBS

SHIPPING WEIGHT: 44.0 LBS

FINISH:

THIRD ANGLE PROJECTION  
ANSI 14.5W

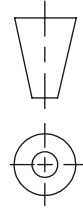

ALL DIMENSIONS ARE IN DECIMAL INCHES  
TOLERANCES UNLESS OTHERWISE SPECIFIED

POLYETHYLENE METAL  
DECIMAL ± .125"  
FRACTION ± 1/4"  
ANGLE ± 1°

DESCRIPTION 110 GALLON FULL DRAIN INDUCTOR TANK

SCALE N.S.

PART NO. INFD110-30

SHEET 1 OF 1